

REPLACEMENT PARTS LIST

RESIDENTIAL SPLIT SYSTEM HEAT PUMP

PSH1BG4CVRX SERIES

19 SEER MODELS

iQ
Drive[®]



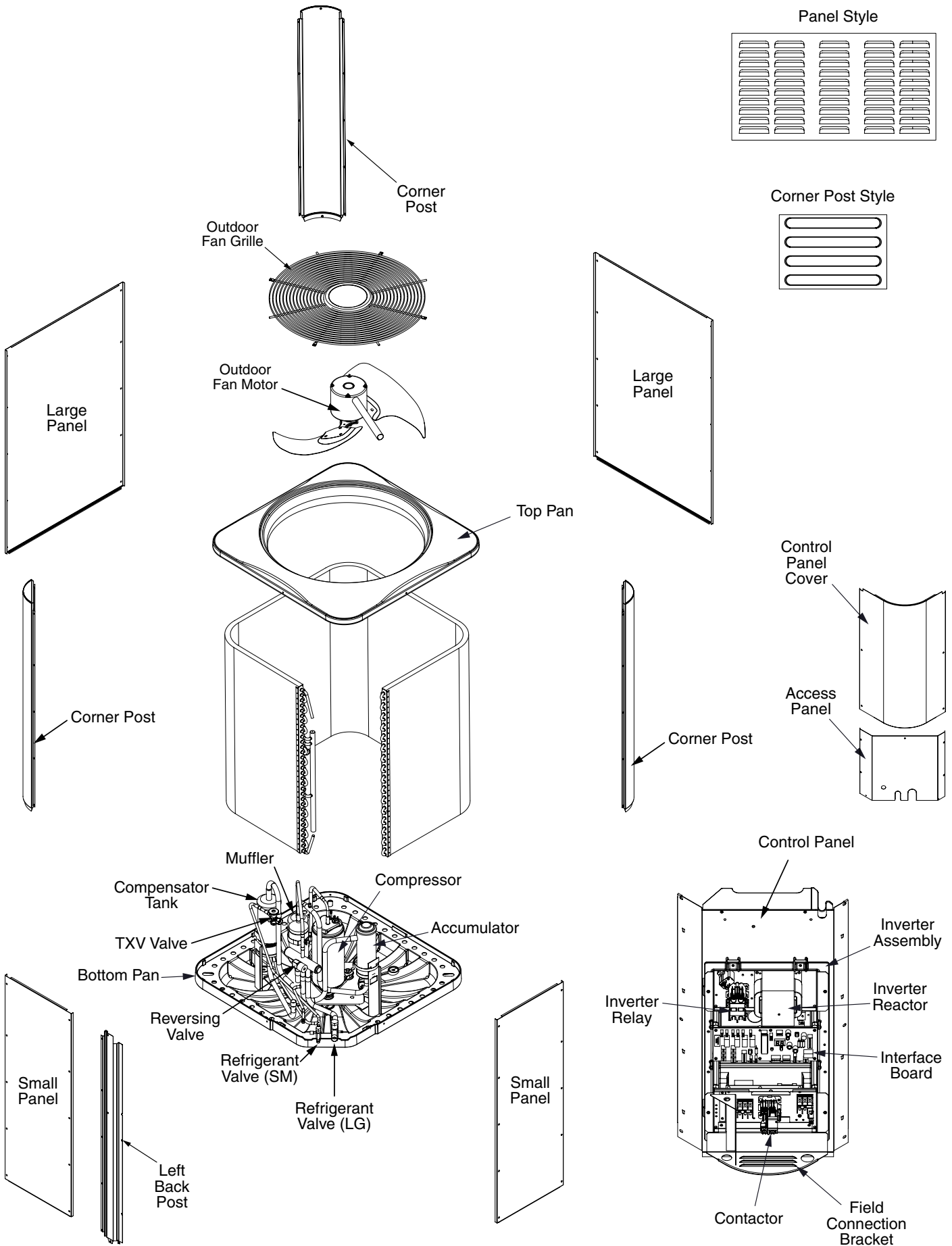

PSH1BG4CVRX SERIES iQDrive RESIDENTIAL SPLIT SYSTEM HEAT PUMP

DESCRIPTION	PSH1BG4CVRX024K	PSH1BG4CVRX036K	PSH1BG4CVRX048K	PSH1BG4CVRX060K
	1017326P	1017327P	1017328P	1017329P
ACCESS PANEL	2C1021BR	2C1021BR	2C1023BR	2C1023BR
ACCUMULATOR	669832R	669833R	669833R	669833R
BOTTOM PAN	1014720	1014720	1014720	1014720
COMPENSATOR TANK	669831	—	669422R	669422R
COMPRESSOR	622515R	622516R	622517R	622518R
COMPRESSOR BASE PAD (NOT SHOWN)	690608R	689975R	689975R	689975R
COMPRESSOR BOLT (NOT SHOWN)	600419R	—	—	—
COMPRESSOR CRANKCASE HEATER (NOT SHOWN)	632538R	632538R	632538R	632538R
COMPRESSOR GROMMET (INCLUDED WITH COMPRESSOR)	669914R	690304R	690304R	690304R
COMPRESSOR SOUND BLANKET (NOT SHOWN)	690526R	690527R	690527R	690528R
CONTACTOR	624713R	624713R	624713R	624714R
CONTROL PANEL (SHEET METAL ONLY)	2C1031R	2C1031R	2C1031R	2C1031R
CONTROL PANEL COVER	101466501BR	101466501BR	101466501BR	101466501BR
FAN MOTOR CONTROL WIRE HARNESS (NOT SHOWN)	634827	634827	634827	634827
FAN MOTOR POWER WIRE HARNESS (NOT SHOWN)	634826	634826	634826	634826
FAN MOTOR WIRE CONDUIT (NOT SHOWN)	664290R	664290R	664290R	664290R
FIELD CONNECTION BRACKET (SHEET METAL WITH LOUVERS)	2C0991BR	2C0991BR	2C0991BR	2C0991BR
FIELD WIRING HARNESS, (6-WIRE) (NOT SHOWN)	2C6131R	2C6131R	2C6131R	2C6131R
FILTER DRIER (NOT SHOWN)	669761R	669761R	669761R	669761R
INVERTER ASSEMBLY	624758R	624759R	624760R	624761R
INVERTER INTERFACE BOARD (INCLUDED WITH INVERTER ASSY)	624767R	624768R	624769R	624770R
INVERTER REACTOR (INCLUDED WITH INVERTER ASSY)	—	—	624796R	624797R
INVERTER RELAY (INCLUDED WITH INVERTER ASSY)	—	—	—	624803R
JACKET, CORNER POST	—	—	101472306BR	101472306BR
JACKET, LARGE PANELS	—	101074204SR	101074206SR	101074206SR
JACKET, LEFT BACK POST	—	—	101450406BR	101450406BR
JACKET, SMALL PANELS	101380404SR	101074404SR	101074406SR	101074406SR
MUFFLER	669546R	669546R	669546R	669546R
OUTDOOR COIL (FORMED)	2B8781R	2B8782R	2B8783R	2B8784R
OUTDOOR FAN BLADE	667351R	667351R	667351R	667351R
OUTDOOR FAN GRILLE	669592R	669591R	669591R	669591R
OUTDOOR FAN MOTOR	622648R	622648R	622648R	1006720R
REFRIGERANT SERVICE VALVE (LIQUID)	663862R	663862R	663862R	663862R
REFRIGERANT SERVICE VALVE (VAPOR)	663864R	663865R	663865R	663865R
REVERSING (4-WAY) VALVE	669465R	M0079102R	M0079102R	M0079102R
REVERSING VALVE COIL & WIRE HARNESS (NOT SHOWN)	669470R	669937R	669937R	669937R
SWITCH, HIGH PRESSURE (NOT SHOWN)	632473R	632473R	632473R	632473R
SWITCH, LOW PRESSURE (NOT SHOWN)	632634R	632634R	632634R	632634R
TEMPERATURE SENSOR, AMBIENT (BLACK) (NOT SHOWN)	624780R	624780R	624780R	624780R
TEMPERATURE SENSOR, COIL (YELLOW) (NOT SHOWN)	624781R	624781R	624781R	624781R
TEMPERATURE SENSOR, COMPR. DISCHARGE (RED) (NOT SHOWN)	624779R	624779R	624779R	624779R
TEMPERATURE SENSOR, DEFROST (WHITE) (NOT SHOWN)	624793R	624793R	624793R	624793R
TEMPERATURE SENSOR, SUCTION (BLUE) (NOT SHOWN)	624782R	624792R	624792R	624792R
TOP PAN	101472501BR	101472101BR	101472101BR	101472101BR
TXV (THERMOSTATIC EXPANSION VALVE)	669956R	669957R	669958R	669958R

Please specify the correct Model No., Serial No., and part number(s) when ordering parts from the nearest authorized Dealer or Service Center.

