

REPLACEMENT PARTS LIST

Single Package Electric Heating / Electric Cooling Heat Pump
Q6SP - 090 / 120 Series
11.0 EER, 3-Phase Models

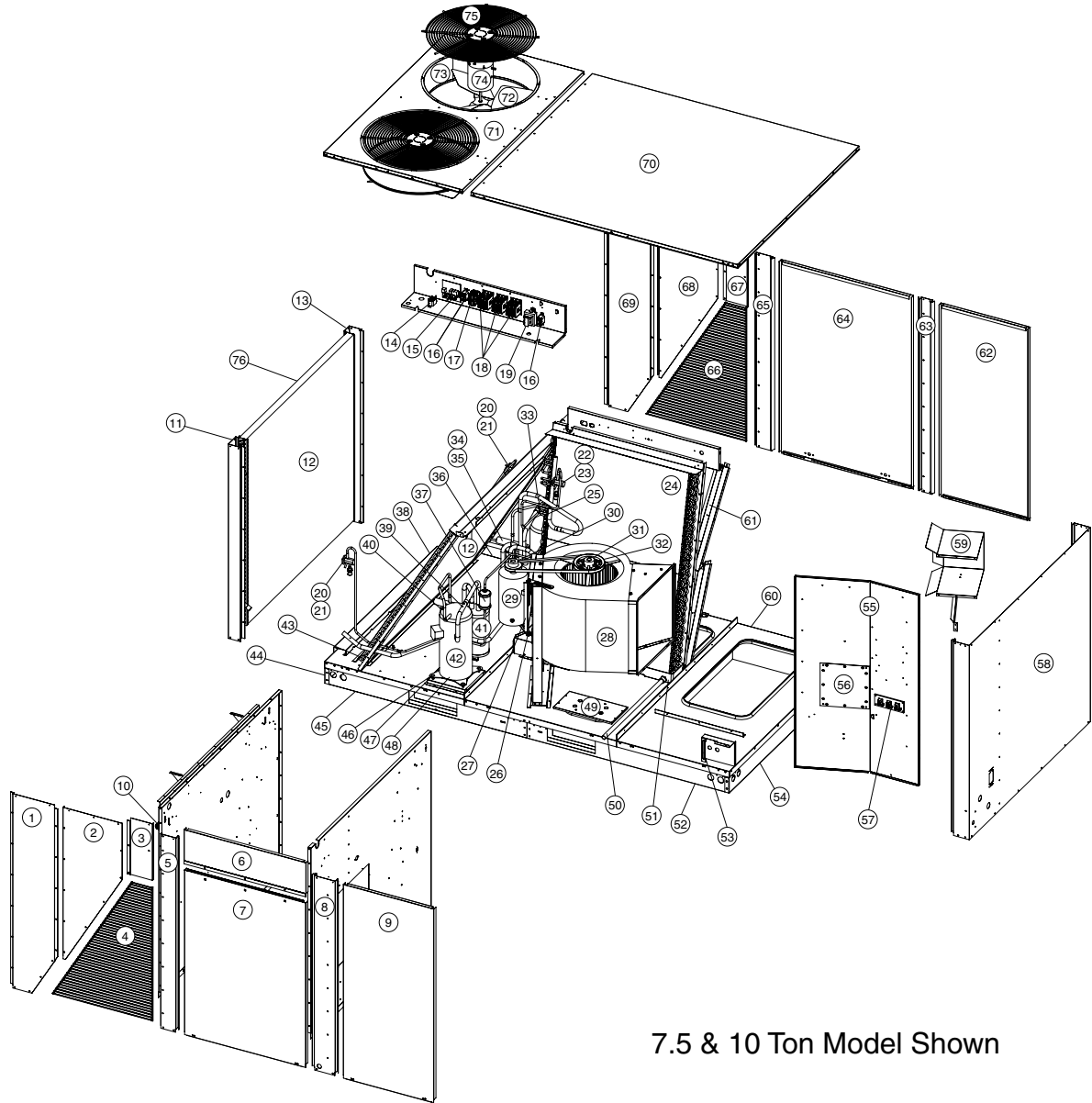

7.5 & 10 Ton Model Shown

IMPORTANT

- This document is primarily intended to assist qualified individuals experienced in the proper repair or servicing of this appliance. Only factory authorized parts or accessory kits may be used with this product. Improper installation, service, adjustment, or maintenance may cause explosion, fire, electrical shock or other hazardous conditions which may result in personal injury or property damage.
- Some local codes require licensed installation / service personnel to service this type of equipment. Under no circumstances should the equipment owner attempt to install parts or service this equipment. Failure to comply with this warning could result in property damage, personal injury, or death.

Q6SP Series Single Package Heat Pump 11.0 EER, 3 Phase Models

ITEM	DESCRIPTION	Q6SP-090*		Q6SP-120*	
		208/230 V 3 Phase	460 V 3 Phase	208/230 V 3 Phase	460 V 3 Phase
1	Panel, Coil Access-Front	291301R	291301R	291301R	291301R
2	Panel, Ext. Condenser-Front	291361R	291361R	291361R	291361R
3	Panel, Wire Access-Front	291371R	291371R	291371R	291371R
4	Guard, Grille, Comp, Closeoff-Front	669625	669625	669625	669625
5	Panel, Ext. Condenser/Blower Divider-Front	M0025180R	M0025180R	M0025180R	M0025180R
6	Panel, Control Access	292131R	292131R	292131R	292131R
7	Panel, Blower Access	M0025173R	M0025173R	M0025173R	M0025173R
8	Panel, Ext. Blower/Heat Exchanger	M0025189R	M0025189R	M0025189R	M0025189R
9	Panel, Element Access	M0025124R	M0025124R	M0025124R	M0025124R
10	Capacitors	622132	622132	622132	622132
11	Post, Corner-Front	288781R	288781R	288781R	288781R
12	Complete Coil Assembly, Outdoor, 7.5 Ton	290811R	290811R	—	—
	Complete Coil Assembly, Outdoor, 10 Ton	—	—	298571R	298571R
13	Post, Corner-Back	288771R	288771R	288771R	288771R
14	Relay, DPDT	622091	622091	622091	622091
15	Board, Defrost, Optional Delay	624656	624656	624656	624656
16	Relay, DPST	621867	621867	621867	621867
17	Contact, 2 Pole	621668	621668	621668	621668
18	Contact, 3 Pole	621832	621832	621832	621832
19	Transformer,208-230V, 75 VA w/ 4 Amp Crkt. Brkr.	621783	—	621783	—
	Transformer,460V, 75 VA w/ 4 Amp Crkt. Brkr.	—	621795	—	621795
20	Outdoor Restrictor, 7.5 Ton (0.067" Dia.)	664067	664067	—	—
	Outdoor Restrictor, 10 Ton (0.080" Dia.)	—	—	664080	664080
	Outdoor Swivel Connection	664194	664194	664194	664194
21	Distributor, Outdoor, 5 Crkt, 7.5 Ton (Not Shown)	663582	663582	—	—
	Distributor, Outdoor, 6 Circuit, 10 Ton (Not Shown)	—	—	663584	663584
22	Thermostatic Expansion Valve-Indoor, 7.5 Ton	669578	669578	—	—
	Thermostatic Expansion Valve-Indoor, 10 Ton	—	—	664894	664894
23	Distributor, Indoor, 6 Crkt, 7.5 Ton (Not Shown)	663638	663638	—	—
	Distributor, Indoor, 7 Circuit, 10 Ton (Not Shown)	—	—	664296	664296
24	Complete Coil Assembly, Indoor, 7.5 Ton	296921R	296921R	—	—
	Complete Coil Assembly, Indoor, 10 Ton	—	—	287821R	287821R
25	Switch, Evaporator Freezestat	626476	626476	626476	626476
26	Belt Tension Bar	606241	606241	606241	606241
27	Motor Mounting Plate	388080R	388080R	388080R	388080R
28	Blower Housing and Wheel - 15 x 15	667285	667285	667285	667285
Low Static Blower Drive Models					
29	Blower Motor, 1.5 HP, 208-230/460V, 3Ph.	622255R	622255R	—	—
	Blower Motor, 2.0 HP, 208-230/460V, 3Ph.	—	—	622254R	622254R
30	Adjustable Motor Sheave, 1VP44 x 7/8"	667317	667317	—	—
	Adjustable Motor Sheave, 1VP40 x 7/8"	—	—	667290	667290
31	Pulley, Indoor Blower, BK95	667373	667373	—	—
	Pulley, Indoor Blower, BK75	—	—	667376	667376
32	Belt, Blower Drive, B52	669431	669431	—	—
	Belt, Blower Drive, B49	—	—	669195	669195

Please specify Model No., Serial No., and the correct part number(s) when ordering parts from the nearest authorized dealer or service center.

Q6SP Series Single Package Heat Pump 11.0 EER, 3 Phase Models

ITEM	DESCRIPTION	Q6SP-090*		Q6SP-120*	
		208/230 V 3 Phase	460 V 3 Phase	208/230 V 3 Phase	460 V 3 Phase
High Static Blower Drive Models					
29	Blower Motor, 2.0 HP, 208-230/460V, 3Ph.	622254R	622254R	—	—
	Blower Motor, 3.0 HP, 208-230V, 3Ph.	—	—	621819R	—
	Blower Motor, 3.0 HP, 460V, 3Ph.	—	—	—	621820R
30	Adjustable Motor Sheave, 1VP50 x 7/8"	667371	667371	667371	667371
31	Pulley, Indoor Blower, BK80	667368	667368	—	—
	Pulley, Indoor Blower, BK75	—	—	667376	667376
32	Belt, Blower Drive, B52	669431	669431	—	—
	Belt, Blower Drive, B51	—	—	669722	669722
33	Switch, High Pressure - Manual Reset [Stg 2]	632507	632507	632507	632507
34	Valve, Reversing	669936	669936	669936	669936
35	Coil, Reversing Valve w/ 124" Power Cord	669938	669938	669938	669938
36	Rail, Base - Back Left	289641R	289641R	289641R	289641R
37	Filter Drier, Bi-Flow, BFK083S	669494	669494	669494	669494
38	Condenser Coil Spacer	290841R	290841R	290841R	290841R
39	Switch, Low Pressure - Auto Reset [Stg 1]	632335	632335	632335	632335
	Switch, Low Pressure - Auto Reset [Stg 2] - Not Shown	632479	632479	632479	632479
40	Switch, High Pressure - Manual Reset [Stg 1]	632506	632506	632506	632506
41	Accumulator	668854	668854	668854	668854
42	Compressor, ZP39K5E-TF5-130 (208-230 V)	920365	—	—	—
	Compressor, ZP39K5E-TFD-130 (460 V)	—	920364	—	—
	Compressor, ZP54K5E-TF5-130 (208-230 V)	—	—	919611	—
	Compressor, ZP54K5E-TFD-130 (460 V)	—	—	—	920139
43	Defrost Sensor	626554	626554	626554	626554
44	Rail, Base - Condenser End	289621R	289621R	289621R	289621R
45	Rail, Base - Front Left	289631R	289631R	289631R	289631R
46	Compressor Bolt, 5/16-18 x 1-1/2"	600400	600400	600400	600400
47	Compressor Mounting Grommet	668530	668530	668530	668530
48	Crankcase Heater - 240V / 40 W [Stg 1] (Not Shown)	632510	—	632510	—
	Crankcase Heater - 240V / 40 W [Stg 2] (Not Shown)	632511	—	632511	—
	Crankcase Heater - 480V / 40 W [Stg 1] (Not Shown)	—	632512	—	632512
	Crankcase Heater - 480V / 40 W [Stg 2] (Not Shown)	—	632513	—	632513
49	Bottom Power Entry Cover	263920R	263920R	263920R	263920R
50	Drain Pipe Assembly	664295R	664295R	664295R	664295R
51	Condensate Drain Pan	669562	669562	669562	669562
52	Rail, Base - Front Right	292051R	292051R	292051R	292051R
53	Terminal Board, Low Voltage	632474	632474	632474	632474
54	Rail, Base - Heat Exchange End	289991R	289991R	289991R	289991R
55	Panel, Electric Element	M0025136R	M0025136R	M0025136R	M0025136R
56	Element Close Off Plate	M0025139R	M0025139R	M0025139R	M0025139R
57	Terminal Board, High Voltage, 3 Pole - 2/0 AWG	632366	632366	632366	632366
58	Panel, Ext. HX End	M0025171R	M0025171R	M0025171R	M0025171R
59	Electric Element Housing	292551R	292551R	292551R	292551R
60	Rail, Base - Back Right	292061R	292061R	292061R	292061R
61	Filters 16 X 25 X 2 - U.L. Class (Not Shown)	668932	668932	668932	668932
62	Panel, HX Tube Access	386152R	386152R	386152R	386152R

Please specify Model No., Serial No, and the correct part number(s) when ordering parts from the nearest authorized dealer or service center.

Q6SP Series Single Package Heat Pump 11.0 EER, 3 Phase Models

Item	Description	Q6SP-090*		Q6SP-120*	
		208/230 V 3 Phase	460 V 3 Phase	208/230 V 3 Phase	460 V 3 Phase
63	Panel, Ext. HX / Evaporator Divider	M0025172R	M0025172R	M0025172R	M0025172R
64	Panel, Evaporator Access	D07162R	D07162R	D07162R	D07162R
65	Panel, Ext. Evaporator / Condenser Divider	M0025174R	M0025174R	M0025174R	M0025174R
66	Guard, Grille, Comp, Closeoff-Back	669673	669673	669673	669673
67	Panel, Wire Access - Back	292001R	292001R	292001R	292001R
68	Panel, Ext. Condenser - Back	291451R	291451R	291451R	291451R
69	Panel, Coil Access - Back	291541R	291541R	291541R	291541R
70	Pan, Heat Exchanger/Evaporator Top	M0025178R	M0025178R	M0025178R	M0025178R
71	Pan, Condenser Top, 24"	295491R	295491R	295491R	295491R
72	Blade, Condenser Fan - 24", 3 Blade	667364	667364	667364	667364
73	Orifice, Condenser- Fan 24"	295481R	295481R	295481R	295481R
74	Motor, Outdoor Fan - 208/230V, 1/3 HP	622252R	—	622252R	—
	Motor, Outdoor Fan - 460V, 1/3 HP	—	622253R	—	622253R
75	Grille, Condenser Fan - 24"	669202	669202	669202	669202
76	Hail Guard, Plastic Mesh	669653	669653	669653	669653

Please specify Model No., Serial No, and the correct part number(s) when ordering parts from the nearest authorized dealer or service center.

NORDYNE
COMPLETE COMFORT. GENUINE VALUE.

Specifications & illustrations subject to change without notice or incurring obligations.
O' Fallon, MO | Printed in U.S.A. (05/11)

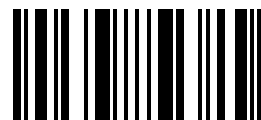

708682A (Replaces 7086820)