

Electric Furnace Downflow Coil Cabinet

Installation Instructions

For Use with E2/E3 Series Electric Furnace Coil Cabinet 904067

INTRODUCTION

These instructions are primarily intended to assist qualified individuals experienced in the proper installation of heating and/or air conditioning appliances. Before beginning the installation, read these instructions thoroughly and follow all warnings and cautions in the instructions and on the unit. Improper installation, service, adjustment, or maintenance can cause explosion, fire, electrical shock, or other conditions which may result in personal injury or property damage.

This coil cabinet is designed for existing downflow furnace installations.

INSTALLATION SEQUENCE

WARNING:

To avoid risk of electric shock, personal injury, or death, disconnect electrical power to the unit before performing any maintenance or service. The unit may have more than one electric power supply.

The installation sequence is as follows:

- 1) Read these installation instructions completely before proceeding.
- 2) Secure the furnace as stated in its installation instructions.
- 3) If a VentilAire is installed on the furnace, remove the duct connector from the E2/E3 furnace and cover the hole with metal tape or sheet metal.
- 4) Position coil cabinet on a flat surface as shown in Figure 1. Remove the 20" x 25" filter and the louvered grille.
- 5) Remove the 16" x 20" filter from the E2/E3 furnace. (The filter retainer from the furnace can be discarded). Place this filter into the filter retainer supplied with the downflow coil cabinet. This will filter the air from the VentilAire and the top opening for 5 ton applications.
- 6) Install the VentilAire duct to the top of the coil box in the oblong hole provided.
- 7) With the grille and 20" x 25" filter removed from the coil box assembly place the coil box on top of the furnace and attach it to the furnace with the screws provided.
- 8) Install the indoor coil per the instructions with the coil.
- 9) Place the 20" x 25" filter in the assembly.
- 10) Install the louvered grille in the door bracket and attach to the top of the cabinet with the pawl latch.

Note: There are two filters in the assembled E2/E3 downflow coil box. One is a 20" x 25" filter located behind the grille. The other is a 16" x 20" filter located in the top of the coil box. Both of these filters are disposable and should be checked and/or replaced once per month or as often as necessary.

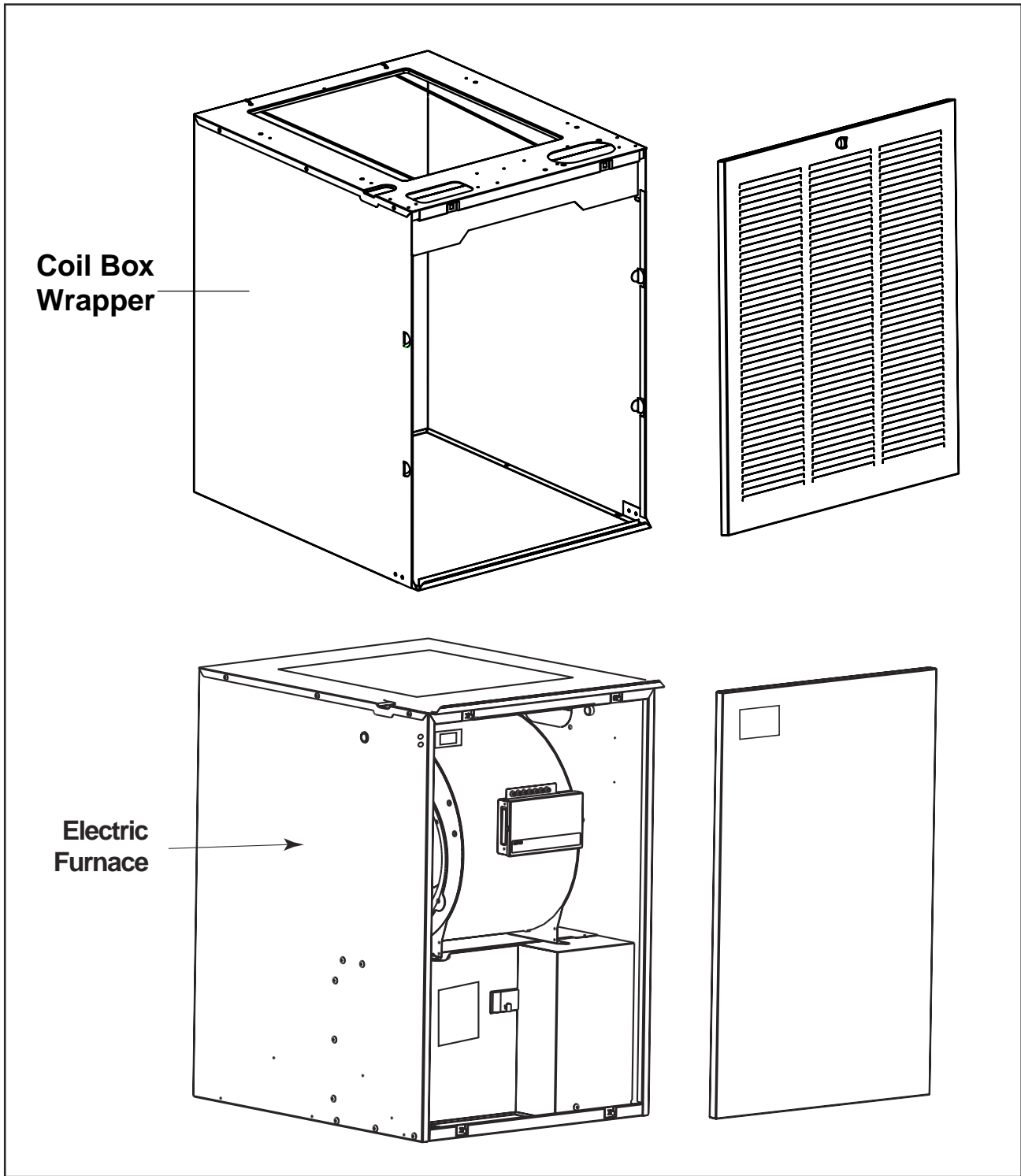

Figure 1

NORDYNE
COMPLETE COMFORT. GENUINE VALUE.

Specifications & illustrations subject to change
without notice or incurring obligations (01/14).



7083910